

January 9-13, 2024, Argonne National Laboratory

# Local Organizing Committee Welcome



Local Organizing Committee  
Argonne National Laboratory



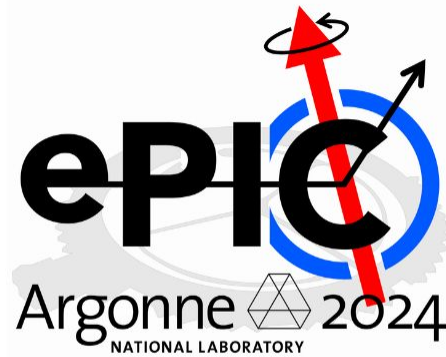

**WELCOME**

**to the ePIC  
Collaboration  
Meeting**

# WEATHER & PRACTICAL INFO



Argonne National Laboratory is a  
U.S. Department of Energy laboratory  
managed by UChicago Argonne, LLC.



# WEATHER UPDATE

Argonne is closed today, but the Lab supports **meeting to go on**

The Lab is prioritizing clearing the roads and walkways between the Guest House and the Venue

Catering will continue as usual

We organized a shuttle service between the Guest House and the Venue today and tomorrow

**Please be careful walking and driving outside!**



# VISITOR BADGE EXTENSIONS

We extended everyone's visitor registration until Tuesday 1/16 in case of travel delays.

**Everyone who was scheduled to leave today but needs to stay longer can pick up an extended visitor badge at the registration desk.**

The same will be the case tomorrow for those leaving tomorrow.

**Please contact the registration desk for questions.**



# PRACTICAL INFO

**Lunches** are served at the Lower Gallery Level: take stairs down from the Atrium level next to the Auditorium

**Coffee Breaks** are arranged at the Atrium (next to the registration desk)

**Shuttle** between Guest House and Venue:

- Friday Morning: 7:30 – 8:00am
- Friday Evening: 6:30 – 7pm
- Saturday Morning: 8:30 – 9am
- Saturday Evening: 6:15pm – 6:45pm

*Important the meeting ends on schedule today and tomorrow as we only have the shuttle for 30 minutes!*



# SAFETY







Argonne National Laboratory is a  
U.S. Department of Energy laboratory  
managed by UChicago Argonne, LLC.



# EVACUATION PLAN—BLDG 402

Key

-  You Are Here
-  Primary Route
-  Secondary Route



## EMERGENCY PHONE NUMBER

Cell Phone: 630-252-1911  
Argonne Land Line: 9-1-1

## EVACUATION PROCEDURE

- In case of fire, activate the nearest fire alarm pull station
- Do Not use elevators
- Leave building immediately using nearest exit and report to Assembly Point

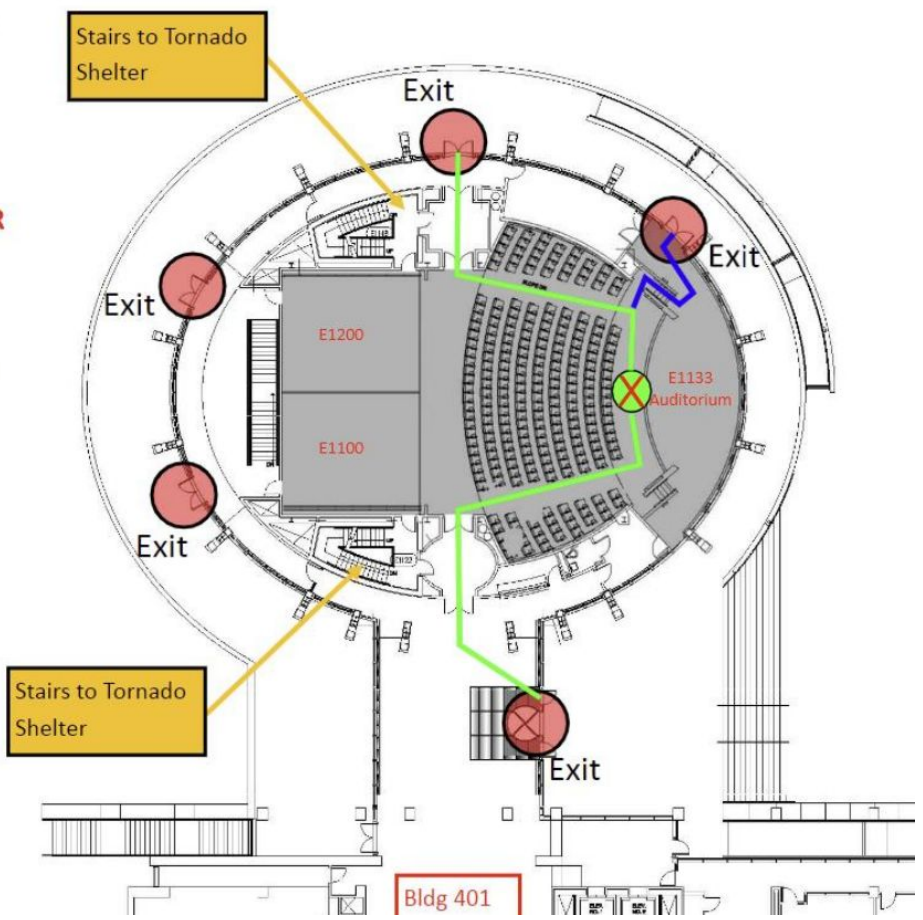



# ASSEMBLY AREA

Proceed along the roadway to the Guest House parking lot

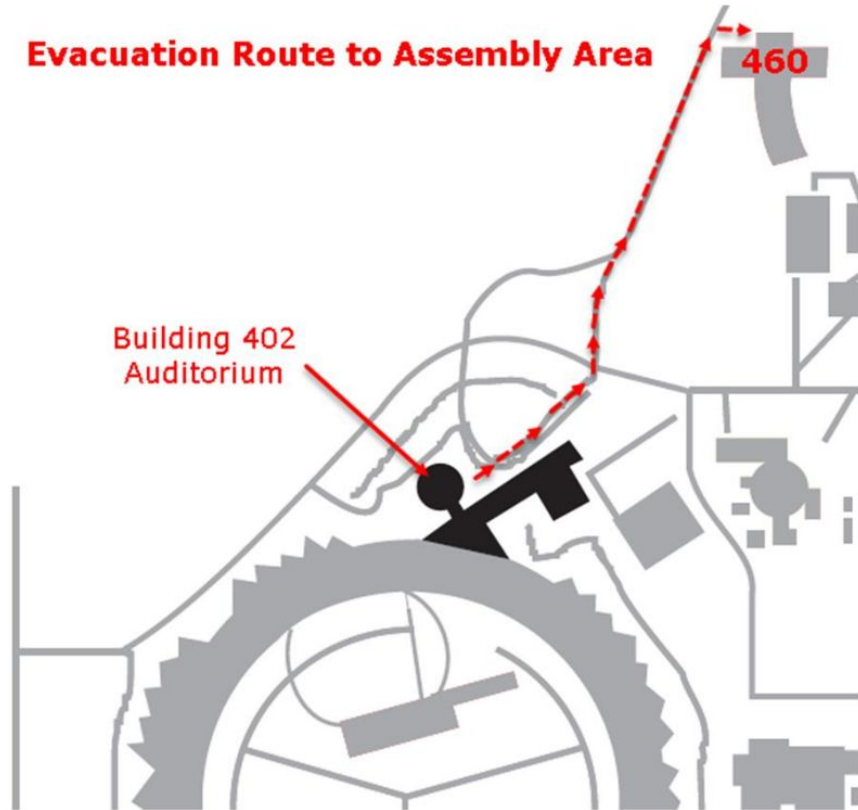

# EMERGENCY SHELTERS

Proceed down the stairs to the Tornado Shelter Areas

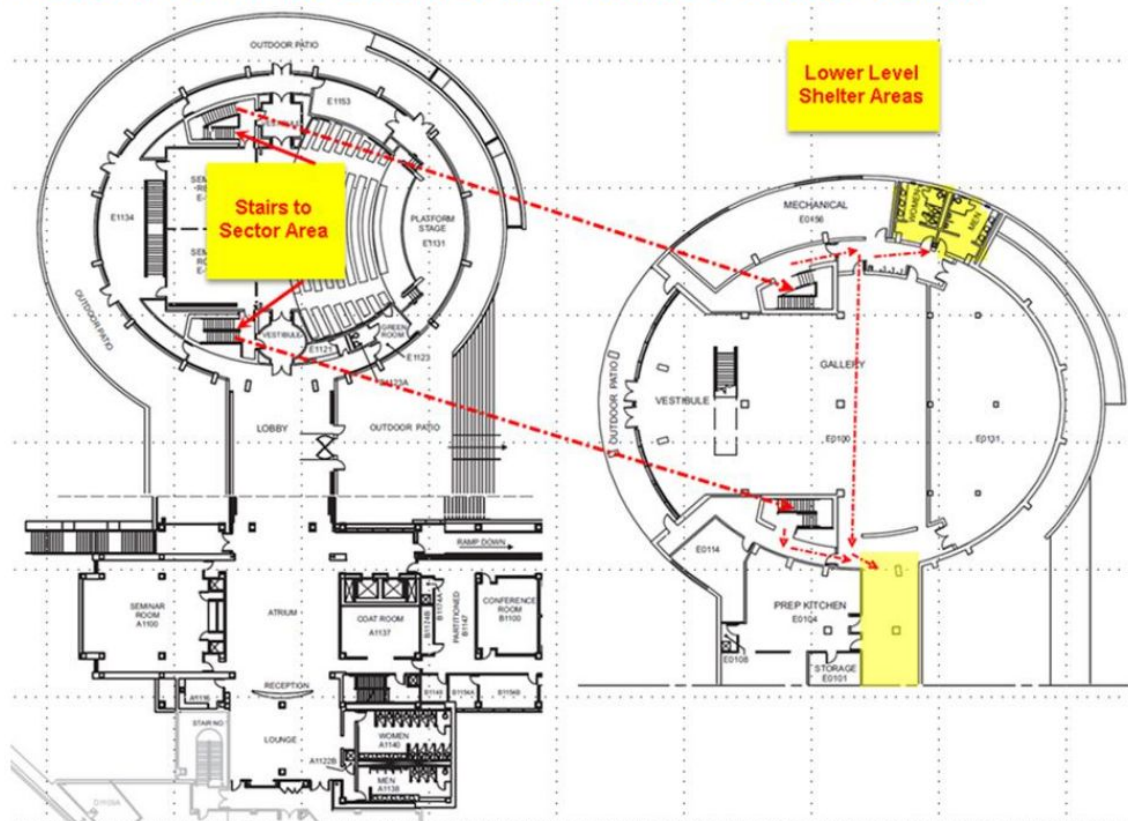



*Please use the stairs to enter the podium*

# WEATHER HEALTH & SAFETY TIPS

Watch out for icy patches in parking lots and sidewalks

Use caution exiting vehicles and walking between buildings

Use main entrances and walkways, as salt and deicing components work better in high-traffic areas

Use the shuttle to come to the venue

Dress in layers and wear a hat

**Be careful!**



Video: [Winter Safety at Argonne: Preventing Slips & Falls](#)



# CODE OF CONDUCT



Argonne National Laboratory is a  
U.S. Department of Energy laboratory  
managed by UChicago Argonne, LLC.



# CODE OF CONDUCT

## Code of Conduct

---

The code of conduct for the ePIC Collaboration Meeting at Argonne follows the core principles of the APS code of conduct for scientific meetings:

### **Professional Conduct:**

All participants will conduct themselves in a professional manner that is welcoming to all and free from any form of discrimination, harassment, or retaliation. Participants will treat each other with respect and consideration to create a collegial, inclusive, and professional environment. Creating a supportive environment to enable scientific discourse is the responsibility of all participants.

### **Inappropriate Actions or Statements:**

Participants will avoid any inappropriate actions or statements based on individual characteristics such as age, race, ethnicity, sexual orientation, gender identity, gender expression, marital status, nationality, political affiliation, ability status, educational background, or any other characteristic protected by law. Disruptive or harassing behavior of any kind will not be tolerated. Harassment includes but is not limited to inappropriate or intimidating behavior and language, unwelcome jokes or comments, unwanted touching or attention, offensive images, photography without permission, and stalking.

<https://indico.bnl.gov/event/20473/page/571-code-of-conduct>

# CODE OF CONDUCT: REPORTING VIOLATIONS

## Reporting Violations:

Violations of this code of conduct policy should be reported to the [Local Organizing Committee Chairs](#). Sanctions may range from verbal warning, to ejection from the meeting without refund, to notifying appropriate authorities. Retaliation for complaints of inappropriate conduct will not be tolerated. If a participant observes inappropriate comments or actions and personal intervention seems appropriate and safe, they should be considerate of all parties before intervening.

## Lead Responders:



Maria Żurek  
zurek@anl.gov



Sylvester Joosten  
sjoosten@anl.gov

You may contact any LOC Member (they wear special badges) to put you in touch with LOC chairs.

<https://indico.bnl.gov/event/20473/page/572-local-organizers>

## Alternative Reporting (outside of LOC):

<https://indico.bnl.gov/event/20473/page/571-code-of-conduct>

# MEETING ANALYTICS



Argonne National Laboratory is a  
U.S. Department of Energy laboratory  
managed by UChicago Argonne, LLC.



# 175 IN-PERSON REGISTRANTS

29% of registered attendants early career, half of those students (24 students)!

Half of the students requested and received travel support.

Workfests have been very successful, with high in-person attendance and very productive discussions

We had 126 people at dinner yesterday!

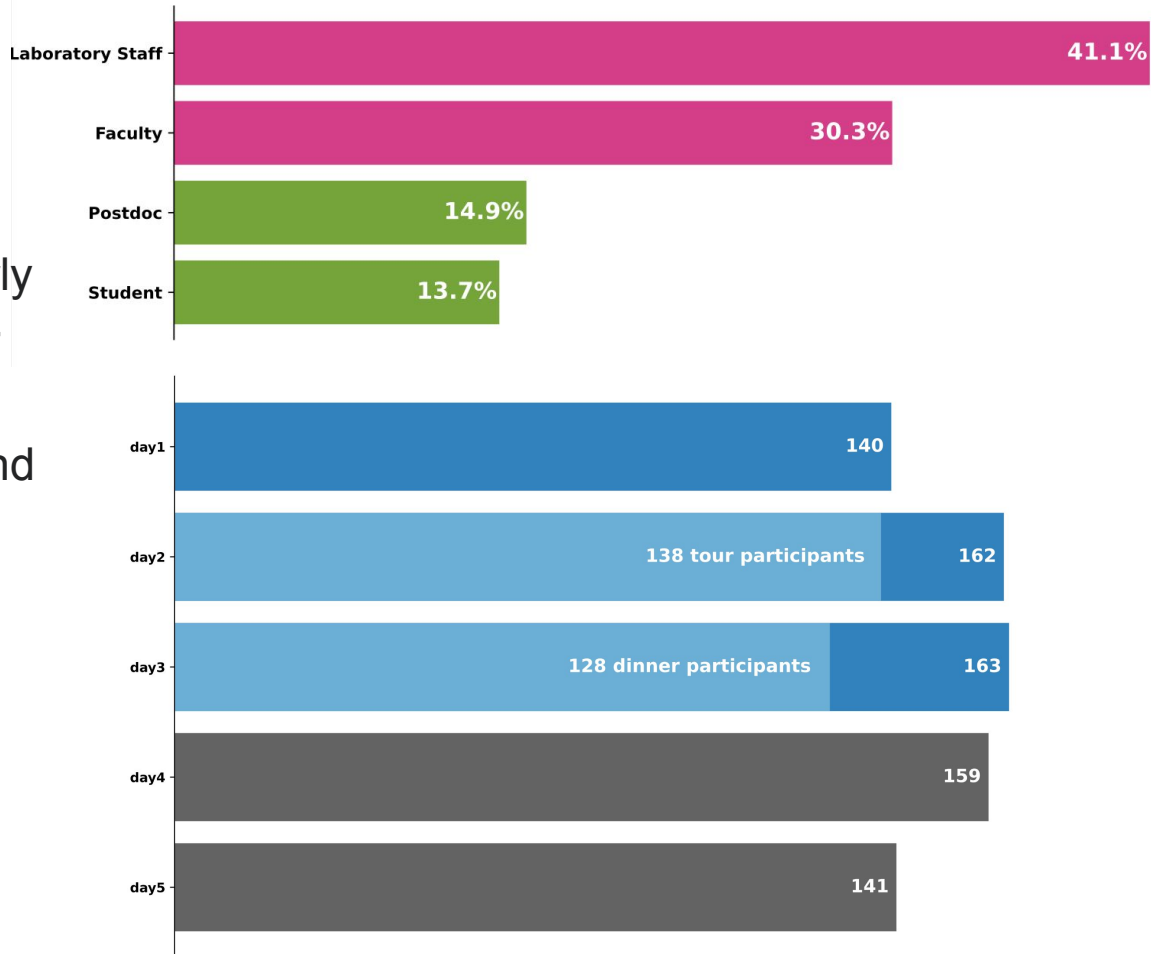

# REGISTRATION BY GENDER

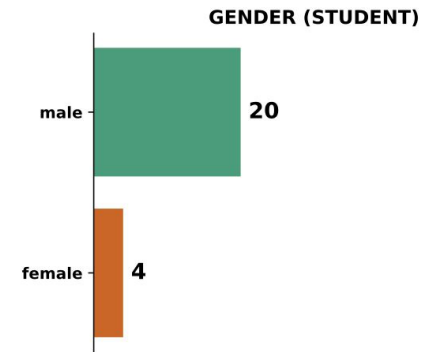
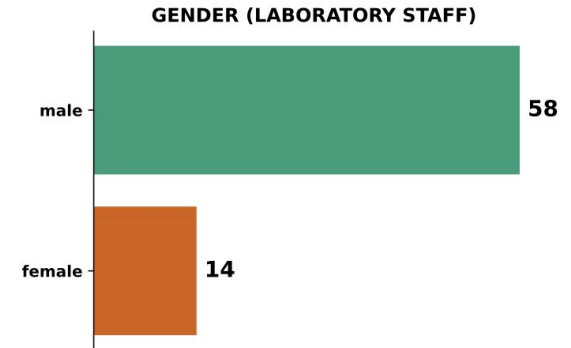
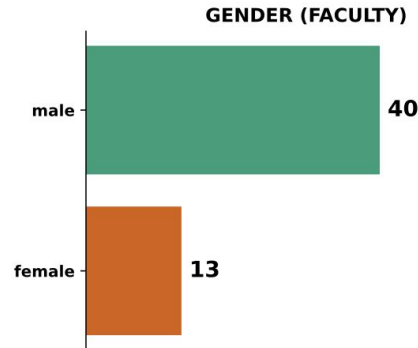
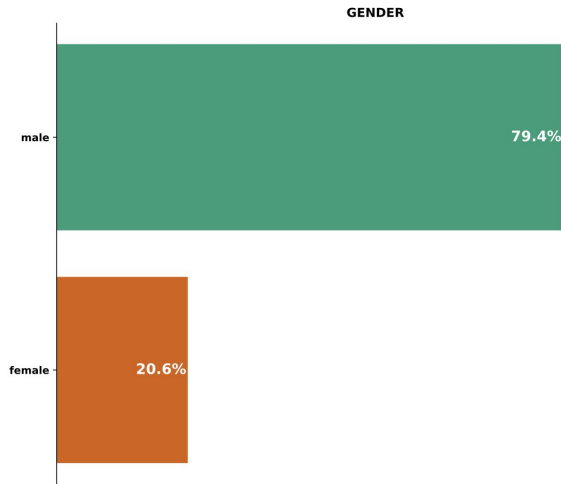

Mirrors overall status in our field

Room for improvement, especially for early-career members

# REGISTRATION BY INSTITUTE

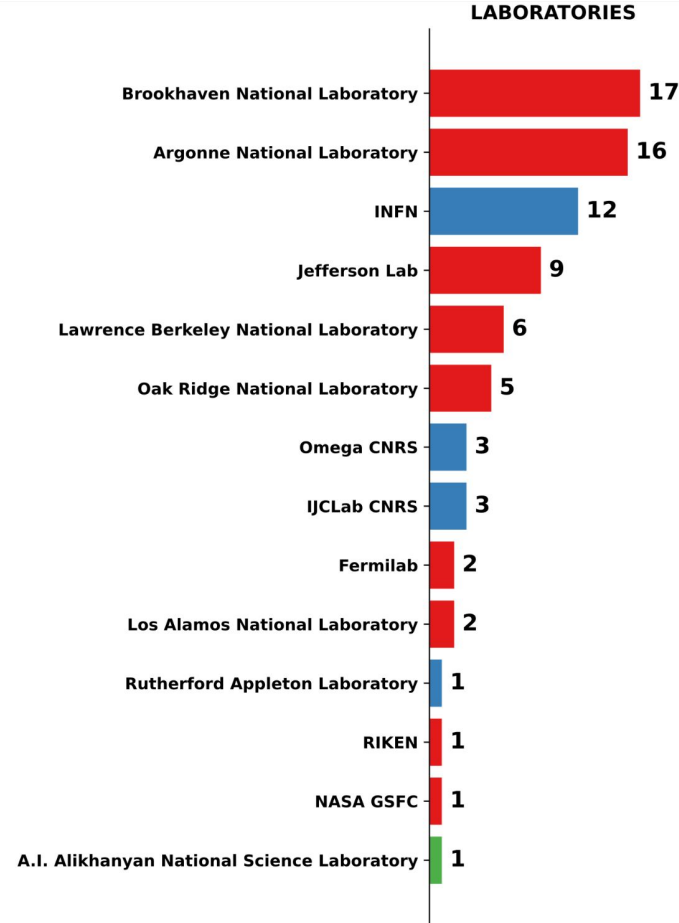
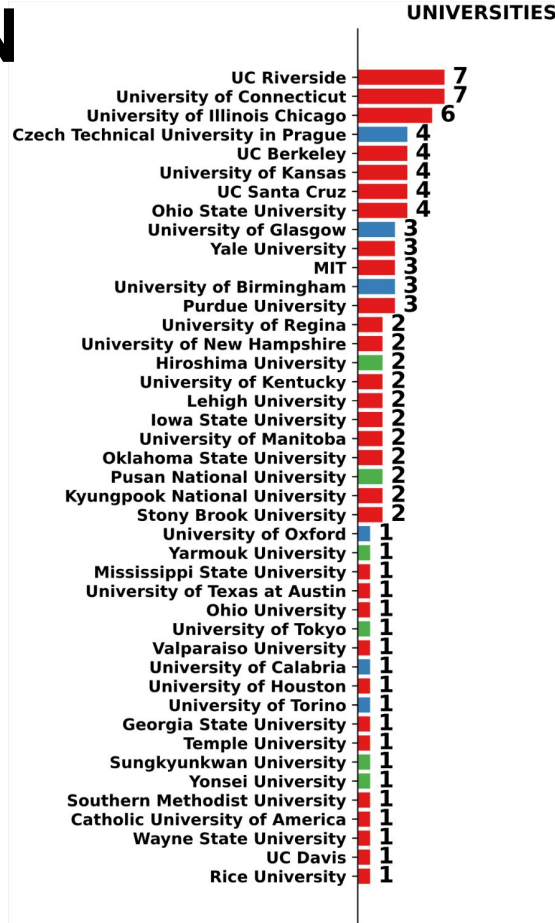
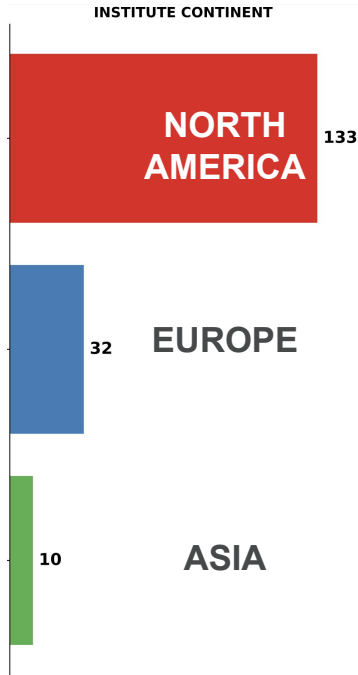

**A SPECIAL THANK YOU TO TO PAULETTE  
DAHLBERG AND LYNNEAN CELMER FOR GOING  
ABOVE-AND-BEYOND**

**THANK YOU ALL FOR  
MAKING THIS MEETING A SUCCESS!**



Argonne National Laboratory is a  
U.S. Department of Energy laboratory  
managed by UChicago Argonne, LLC.





# INTERNET CONNECTION

Argonne offers **eduroam**

- Connect with your institution credentials

For **argonne-guest**

- See the instructions on the right
- Instructions also available at the registration desk

1

## Register as a guest.

1. Open the list of available wireless networks on your device.
2. Select **Argonne-guest**.



3. Once selected, click "Register as Guest" in the screen that pops up.



2

## Create a guest account.

1. Select **Register as a Guest** from the portal screen.
2. Fill out the information.

Argonne

### Create Account

Provide us with some information so we can create an account for you.

First name\*

Last name\*

Email address\*

Phone number

Building where you will be located\*

Person you are visiting\*

3. The next screen displays your username and password. Save them for future use. *Your username and password will also be sent to the registered email account.*

3

## Log on with Argonne credentials.

You should now be able to connect to the Argonne-guest Wi-Fi network using the credentials given to you.

Argonne

### Create Account

Provide us with some information so we can create an account for you.

First name\*

Last name\*

Email address\*

Phone number

Building where you will be located\*

Person you are visiting\*