

pfRICH Engineering/Design Update

Alex Eslinger (JLab)

11/2/23

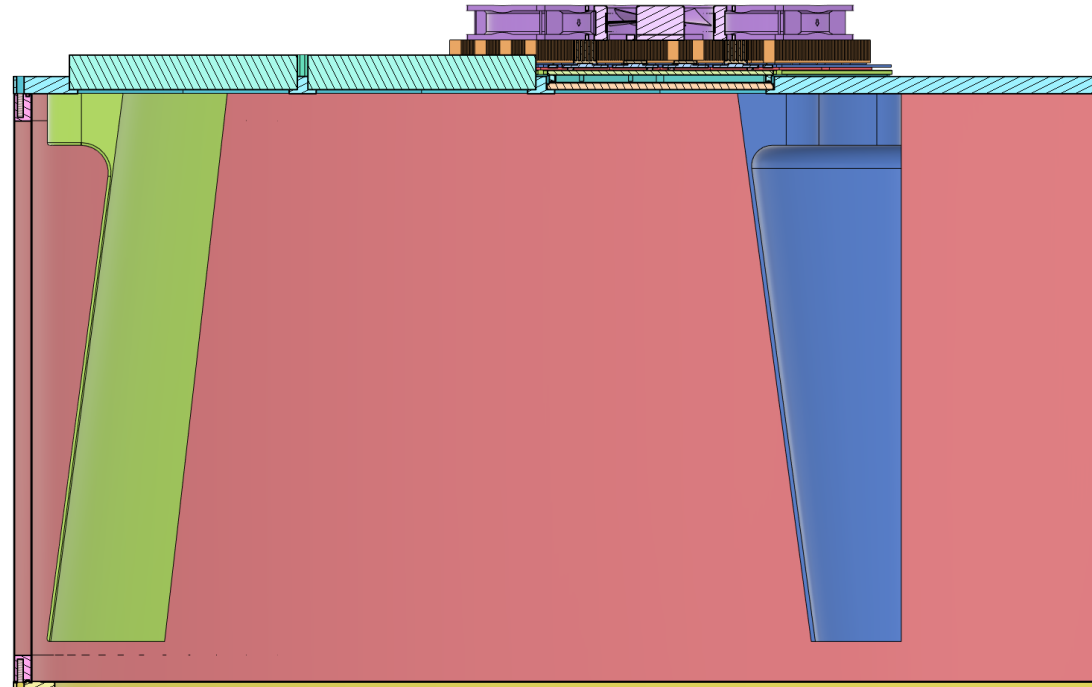
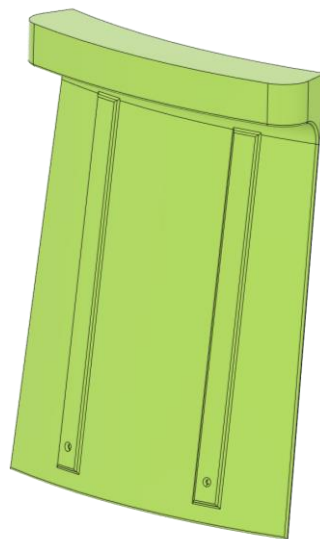
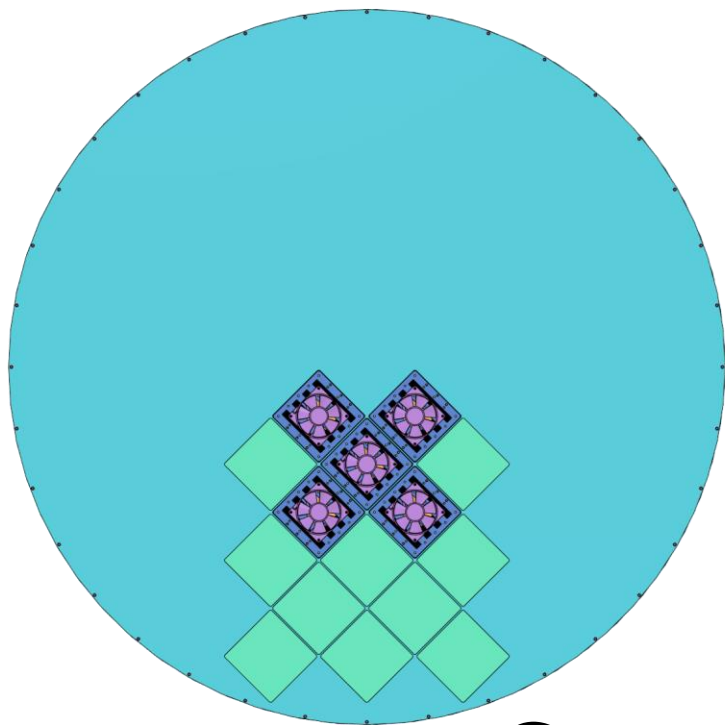

Current Prototype Views

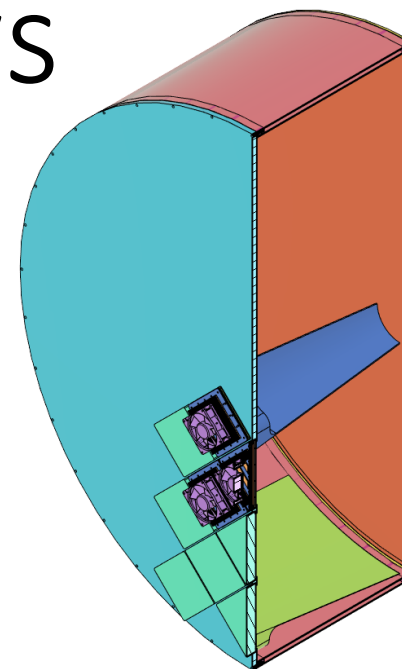
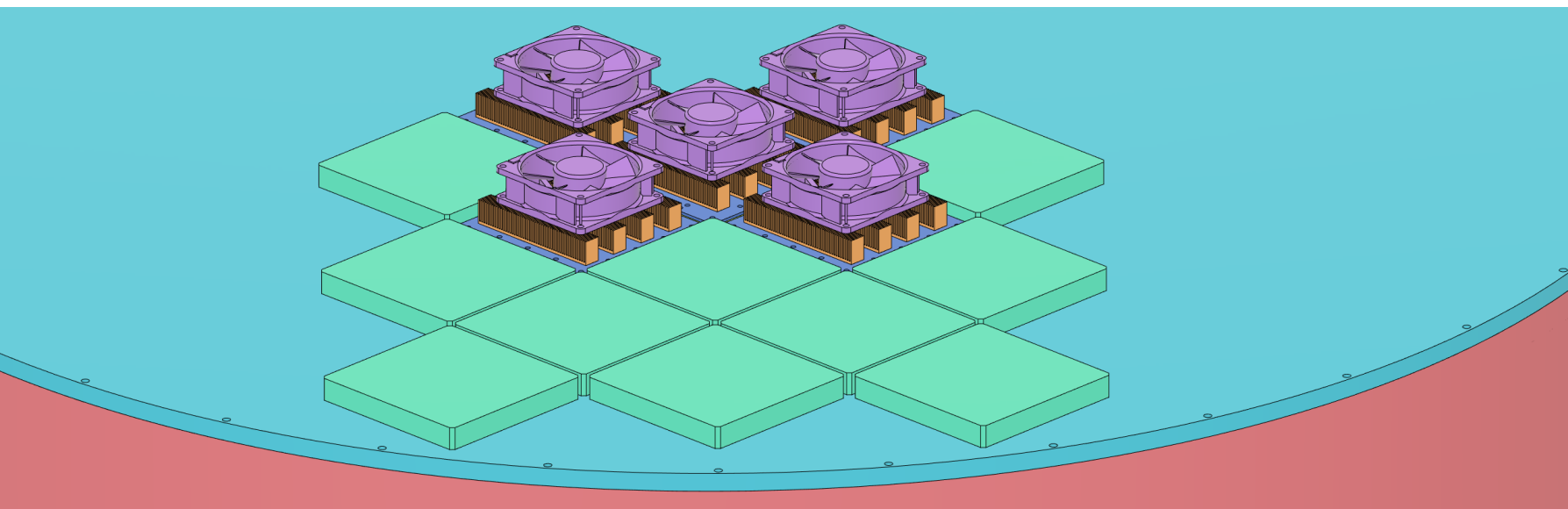

PED Proposals

- All four PED requests are in the works
 - Still receiving comments
 - Past the draft stage

General Notes

- We discussed a few HRPPD sealing schemes (to the sensor plane)
- The priority of the remaining design details was questioned and determined
 - Immediate priority is to get the mirrors, end rings, and the outer cylinder to the final design stage by the EOM (end of month) – November '23 – to ensure we can hit our milestones (beam test by ~mid-May '24)
 - Sensor plane, aerogel plane, and center support column will need to be finalized by EOM January '24.
- After the meeting, the final dimensions for the mirrors were pulled from the simulation (Chandra) and finalized for the prototype

pfRICH Mirror Dimensions

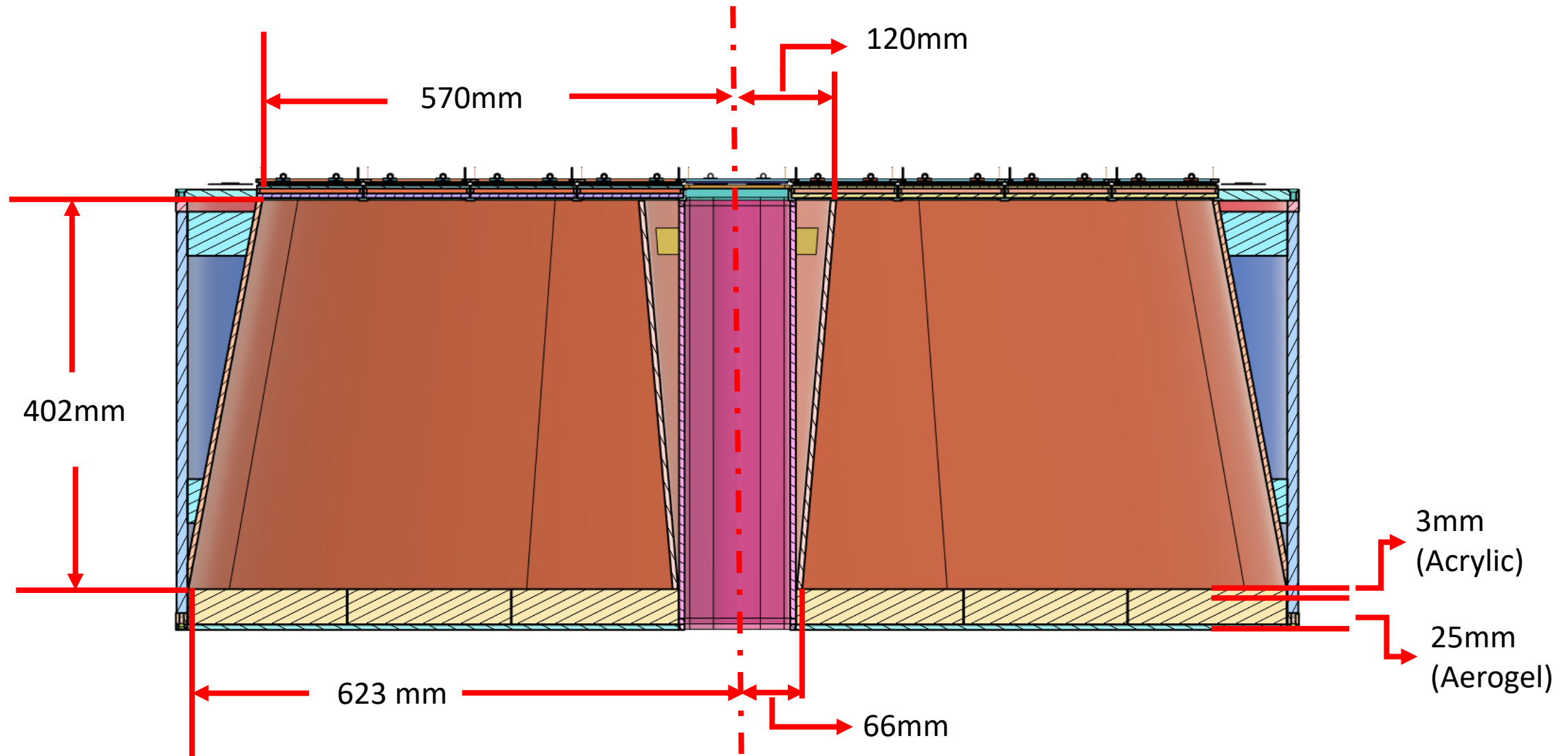

Schedule

- A schedule has been created that reflects the design milestones as well as some negotiated timelines for SBU and Purdue's contributions.
- Alexander is working on finalizing and publishing this schedule

Tasks and Questions

- Questions related to the manufacturing and tolerancing for the end ring, outer cylinder, and mirrors have been sent out to Purdue and SBU
 - Both SBU and Purdue agreed to present information at the next engineering/design meeting (6 Nov 23 – 1300 EST)
- This information will help me perform the design tasks to reach a final design on these three components by the end of the month.

Questions?