

ePIC LFHCal geometry update

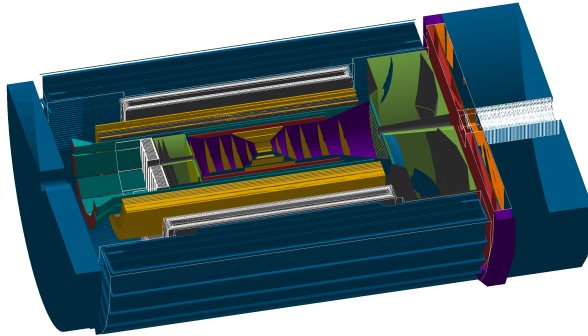

Nicolas Schmidt (ORNL)



Geant4 Model changes

https://github.com/eic/epic/tree/lfhcal_geoupdate

- Module geometry updated with latest setup
- 60 layers of steel and scintillators
→ removal of tungsten
- Adjustment of module size for tolerances
- Addition of mounting plate
→ shown in purple as part of module
→ will be moved to support structure instead

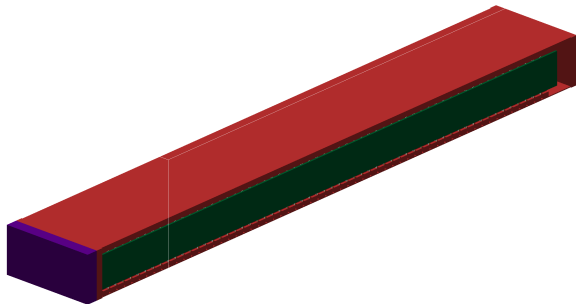

New tower arrangement

- New arrangement in octagonal shape
→ necessary for new support structure
- Same cutout for insert as before
- Current support structure not yet updated
→ being worked on (.stl file available)
- Other TODO: conversion of forward ECal to tower structure

